

Handwheels

with safety grip

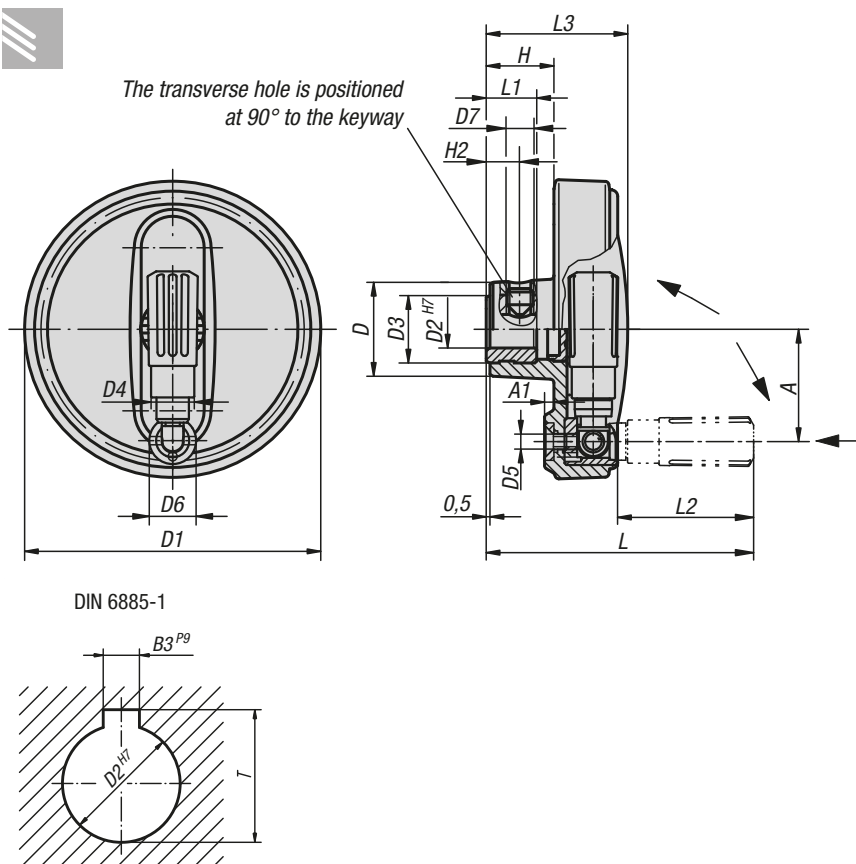

Material:

Black grey thermoplastic.

Version:

Steel parts black oxidised.

Sample order:

K0259.108008

Note:

The hub cover is supplied loose. The handwheels can be secured using a transverse pin or by parallel key connection together with a DIN 6912 socket head screw and a DIN 7349 washer.

Two steps have to be carried out to bring the cylindrical safety grip into operating position:

- Swivel the grip around the axis of rotation until it stops (90°).
- Push grip in axial position into locking position.

The pressed-in position is the most comfortable position to crank. When released, the grip automatically returns to original position.

Versions with transverse bore are secured using the ISO 4027 (DIN 914) grub screw.

For assembly examples, see K0256.

KIPP Handwheels with safety cylinder grip

Order No. reamed hole	Order No. reamed hole with slot	D	D1	D2	D3	D4	D5	D6	A	A1	H	L	L1	L2	L3	B3	T
K0259.108008	K0259.10800802	25	80	8H7	19	14	M4	13	30	2,5	17,6	72,6	13	38	36,7	-/2	-/9
K0259.108010	K0259.10801003	25	80	10H7	19	14	M4	13	30	2,5	17,6	72,6	13	38	36,7	-/3	-/11,4
K0259.108012	K0259.10801204	25	80	12H7	19	14	M4	13	30	2,5	17,6	72,6	13	38	36,7	-/4	-/13,8
K0259.210010	K0259.21001003	28	100	10H7	19	16	M5	16	38	3	20,1	88,6	13	47,5	43,5	-/3	-/11,4
K0259.210012	K0259.21001204	28	100	12H7	19	16	M5	16	38	3	20,1	88,6	13	47,5	43,5	-/4	-/13,8
K0259.312512	K0259.31251204	35	125	12H7	25	20	M6	20	47,5	4	23,3	107,7	18,5	58,4	52,1	-/4	-/13,8
K0259.312514	K0259.31251405	35	125	14H7	25	20	M6	20	47,5	4	23,3	107,7	18,5	58,4	52,1	-/5	-/16,3
K0259.312516	K0259.31251605	35	125	16H7	25	20	M6	20	47,5	4	23,3	107,7	18,5	58,4	52,1	-/5	-/18,3
K0259.416014	K0259.41601405	45	160	14H7	25	25	M8	26	62	5,6	28	142	18,5	81,6	63,8	-/5	-/16,3
K0259.416016	K0259.41601605	45	160	16H7	25	25	M8	26	62	5,6	28	142	18,5	81,6	63,8	-/5	-/18,3

KIPP Handwheels with safety cylinder grip with transverse bore

Order No. reamed hole	Order No. reamed hole with slot	D	D1	D2	D3	D4	D5	D6	D7	A	A1	H	H2	L	L1	L2	L3	B3	T
K0259.1080086	K0259.108008026	25	80	8H7	19	14	M4	13	M6	30	2,5	17,6	7,5	72,6	13	38	36,7	-/2	-/9
K0259.1080106	K0259.108010036	25	80	10H7	19	14	M4	13	M6	30	2,5	17,6	7,5	72,6	13	38	36,7	-/3	-/11,4
K0259.1080126	K0259.108012046	25	80	12H7	19	14	M4	13	M6	30	2,5	17,6	7,5	72,6	13	38	36,7	-/4	-/13,8
K0259.2100106	K0259.210010036	28	100	10H7	19	16	M5	16	M6	38	3	20,1	7,5	88,6	13	47,5	43,5	-/3	-/11,4
K0259.2100126	K0259.210012046	28	100	12H7	19	16	M5	16	M6	38	3	20,1	7,5	88,6	13	47,5	43,5	-/4	-/13,8
K0259.3125126	K0259.312512046	35	125	12H7	25	20	M6	20	M6	47,5	4	23,3	7,5	107,7	18,5	58,4	52,1	-/4	-/13,8
K0259.3125146	K0259.312514056	35	125	14H7	25	20	M6	20	M6	47,5	4	23,3	7,5	107,7	18,5	58,4	52,1	-/5	-/16,3
K0259.3125166	K0259.312516056	35	125	16H7	25	20	M6	20	M6	47,5	4	23,3	7,5	107,7	18,5	58,4	52,1	-/5	-/18,3
K0259.4160146	K0259.416014056	45	160	14H7	25	25	M8	26	M6	62	5,6	28	7,5	142	18,5	81,6	63,8	-/5	-/16,3
K0259.4160166	K0259.416016056	45	160	16H7	25	25	M8	26	M6	62	5,6	28	7,5	142	18,5	81,6	63,8	-/5	-/18,3