

## Spherical knobs

revolving

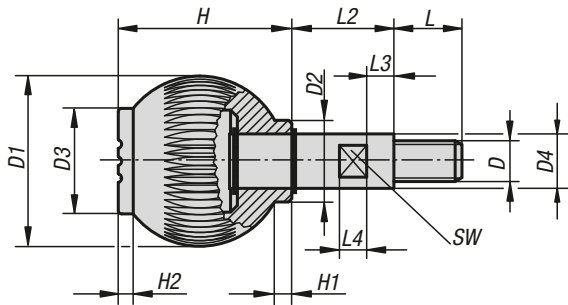

**Material:**

Thermoplastic, black grey.  
Axis steel 5.8 or stainless steel 1.4305.

**Version:**







Trivalent blue passivated steel or bright stainless steel.  
Circlips electro zinc-plated, including stainless steel version.

**Sample order:**

K0254.1066 (cap colour traffic red.)

**Note:**

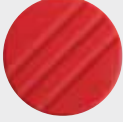
Δ Add the desired cap colour here.  
No colour code is required for black grey caps.

black grey  RAL 7021	pure orange Δ = 1  RAL 2004	signal green Δ = 2  RAL 6032	traffic blue Δ = 3  RAL 5017
light grey Δ = 5  RAL 7035	traffic red Δ = 6  RAL 3020	colza yellow Δ = 7  RAL 1021	

**KIPP Spherical knobs revolving**

Order No. steel	Order No. stainless steel	D	D1	D2	D3	D4	H	H1	H2	L	L2	L3	L4	SW
K0254.106Δ	K0254.0106Δ	M6	25	12	17	8	25	3	2	10	15	5	5	7
K0254.208Δ	K0254.0208Δ	M8	32	15,5	19	10	33	3,5	2,6	12	20	6	6	8
K0254.310Δ	K0254.0310Δ	M10	40	19	23	13	41	4	3	15	25	7	10	10
K0254.412Δ	K0254.0412Δ	M12	50	24	31	16	51	5,5	4,5	20	30	8	8	13