

Chock clamps

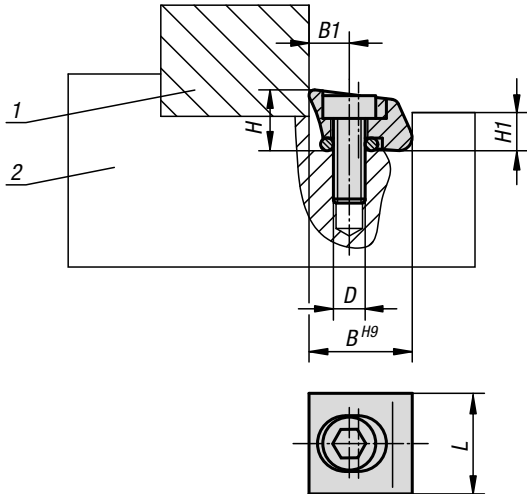

Material:
Clamping element steel or brass.

Version:
Steel hardened.

Sample order:
K0030.113

Note:
Also known as pitbull clamps.
Extremely space-saving design.
No protruding edges due to lateral clamping.
Positive down force.

Drawing reference:
1) workpiece
2) Fixture

KIPP Chock clamps

Order No.	Version	Main material	D	B	B1	H	H1	L	Clamping travel	Clamping force kN	Tightening torque max. Nm
K0030.110	with knife edge	steel	M2,5x8	9,5	3,8	6	3,6	9,5	0,15	2,8	1,8
K0030.113	with knife edge	steel	M4x12	12,7	5,1	8	4,8	13	0,4	6,6	5,6
K0030.119	with knife edge	steel	M6X16	19,05	7,6	11,5	7,2	19	0,6	16	22,5
K0030.210	with blunt edge	steel	M2,5x8	9,5	3,8	6	3,6	9,5	0,15	2,8	1,8
K0030.213	with blunt edge	steel	M4x12	12,7	5,1	8	4,8	13	0,4	6,6	5,6
K0030.219	with blunt edge	steel	M6X16	19,05	7,6	11,5	7,2	19	0,6	16	22,5
K0030.310	with blunt edge	brass	M2,5x8	9,5	3,8	6	3,6	9,5	0,15	0,9	0,56
K0030.313	with blunt edge	brass	M4x12	12,7	5,1	8	4,8	13	0,4	1,8	2,8
K0030.319	with blunt edge	brass	M6X16	19,05	7,6	11,5	7,2	19	0,6	4,2	5,6