

● Steel

Low profile head  
Hexagonal shank  
Open

Zinktop (A)  
Zinc plated, yellow passivated (B)



**HUKO/HSKO**

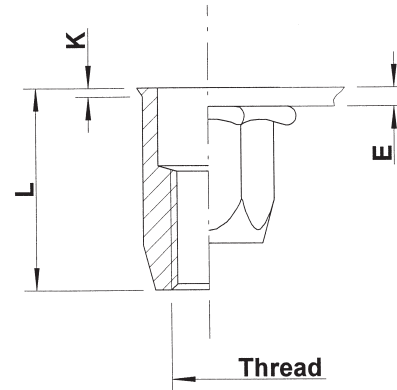
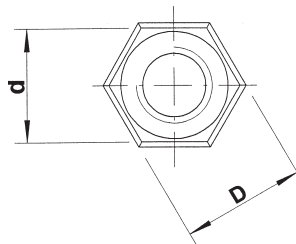
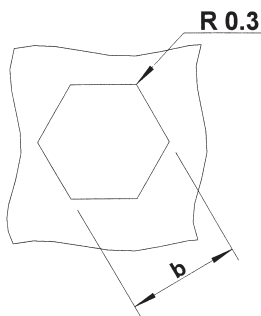

THREAD	TYPE	E = grip	L	b <sup>+0,1</sup> = hex hole	d = hex shank	D = hex head	K	kg/1000	ORDER CODE (A)	ORDER CODE (B)
M4	HUKO20	0,5-2,0	11,0	6,0	6,0	6,6	0,6	1,2	524 629	524 620
M5	HUKO30	0,5-3,0	14,0	7,0	7,0	7,7	0,6	2,0	525 609	525 600
	HUKO55	3,0-5,5	16,5					2,3	525 629*	525 620*
M6	HUKO30	0,5-3,0	16,0	9,0	9,0	9,8	0,7	4,2	526 589	526 580
	HUKO55	3,0-5,5	18,5					4,6	526 609	526 600
M8	HUKO30	0,5-3,0	18,0	11,0	11,0	11,8	0,7	6,2	528 549	528 540
	HUKO55	3,0-5,5	20,5					6,9	528 569	528 560
M10	HSKO35	0,8-3,5	23,0	13,0	13,0	13,8	0,7	10,5	520 669	520 660

\* Minimum order quantity required after depletion of stock

All dimensions in mm  
Technical data subject to modification

