

● Stainless Steel 304

Low profile head
Semi-hexagonal shank
Closed

HUKX

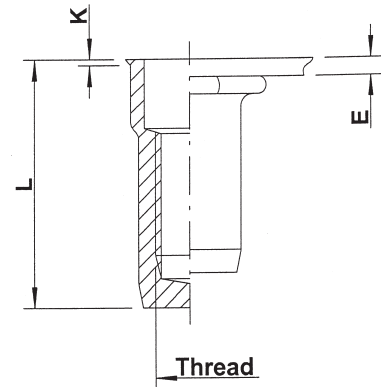
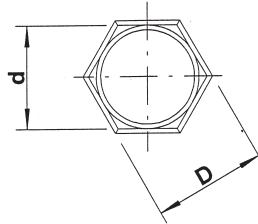
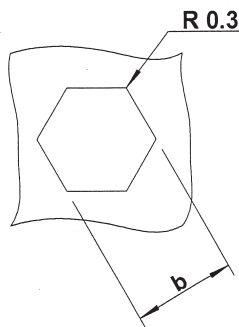

THREAD	TYPE	E = grip	L	b ^{+0,1} = hex hole	d = hex shank	D = hex head	K	kg/1000	ORDER CODE
M4	HUKX20	0,5-2,0	15,5	6,0	6,0	6,5	0,5	1,8	544 620
M5	HUKX30	0,5-3,0	18,0	7,0	7,0	7,5	0,5	2,7	545 620
	HUKX50	3,0-5,0	20,5						545 640*
M6	HUKX30	0,5-3,0	21,5	9,0	9,0	9,5	0,5	5,7	546 540
	HUKX50	3,0-5,0	23,5						546 565*
M8	HUKX30	0,5-3,0	24,0	11,0	11,0	11,5	0,5	8,7	548 320
	HUKX55	3,0-5,5	26,5						548 340

* Minimum order quantity required after depletion of stock

All dimensions in mm
Technical data subject to modification

