

- Ambidextrous installation for handle orientation consistency
- Lightweight, durable corrosion resistant material
- Stylish, ergonomic design for product differentiation
- Slam to close rotary action cam for easy opening

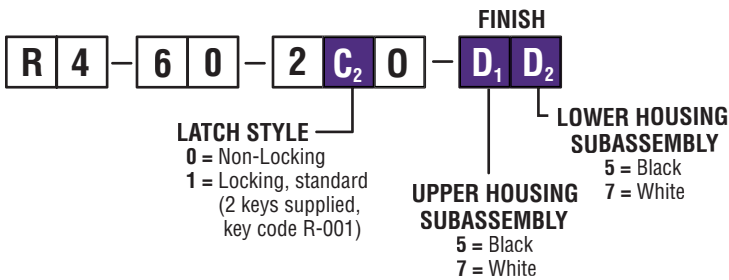
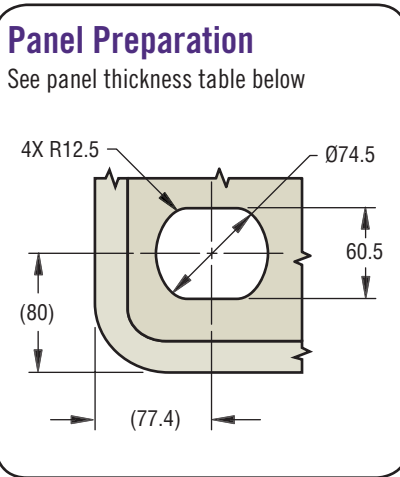
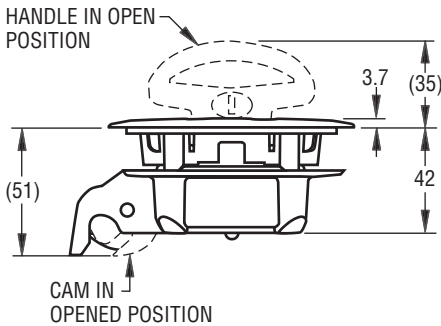
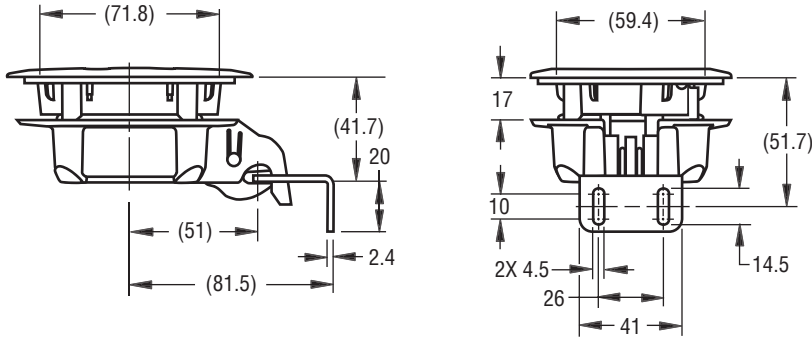

PANEL THICKNESS	4mm Spacers Required (Part Number R4-64-13-1)	8mm Spacers Required (Part Number R4-64-13-2)
1 - 4.9mm	0	2
5 - 9.9mm	1	1
10 - 14.9mm	0	1
15 - 19.9mm	1	0
20 - 23.9mm	0	0

NOTE: Panel thickness greater than 23.9mm can be accommodated, call Southco for details. Part Number includes four screws and 2 flat keys on a ring. Striker ordered separate: R4-64-11

- ### Material and Finish
- UPPER HOUSING AND HANDLE: PC + ABS, PC + PBT, or GFPP. See part number table for finish.
 LOWER HOUSING: Glass filled nylon. See part number table for finish.
 GASKET and SEALING WASHER: Sponge, gray or black
 SEAL COMPOUND: Commercial standard nitrile
 RETAINER MATERIAL: Low carbon steel, zinc plated
 CAM SPRING: 302 stainless steel, passivated
 CAM and PLUNGER: Glass filled nylon, black
 COIL PIN: 302 stainless steel, passivated
 COMPRESSION and TORSION SPRING: 302/304 stainless steel, passivated
 LOCK PLATE: Acetal, black
 LOCK PLUG: Zinc die cast, stainless steel scalp

Application:

1. Maximum recommended tightening torque on mounting screws is 1.8 Nm.
2. Maximum recommended working load exerted by keeper on cam is 355 N. Average ultimate load is 750 N.

All dimensions on this page are in millimeters.